

## 超薄型夾盤

- 1.輕、薄、短小的設計，適用於工件量測夾持。
- 2.直接轉動旋盤，免於使用板手旋轉干涉。
- 3.鋼製本體，耐用性甚佳。
- 4.夾爪正反夾持兩用設計，操作方便。
- 5.2"最小工件夾持0.8mm。

### 尺寸圖 » Dimensions

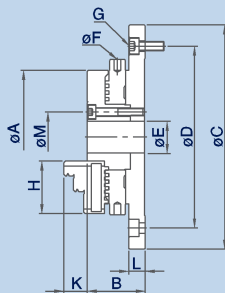
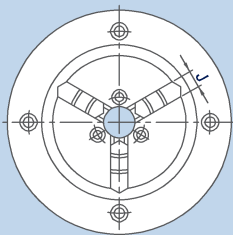

1. By the compactness comes from " Light, Thin, Short, Small " designing concept; the chucks are most fitting to hold work pieces for measuring.
2. Just rotate the chuck knob directly for gripping and loosening, A handle is not necessary to be used.
3. Chuck body is made of very durable steel.
4. Jaws can be reversibly used; gripping of various sizes becomes much convenient.
5. 2" chucks can even grip up to the smallest size of 0.8mm.

### 規格表 » Specifications

單位/UNIT:mm

型式/規格 MODEL / SPEC.	A	B	C	D	E	F	G	H	J	K	L	M	把握範圍 Max. Gripping Diameter		淨重 Weight (kg)
													外徑把握 O.D. Clamping (mm)	內徑把握 I.D. Clamping (mm)	
SE-02	63	28	118	100	16	4	4-M5x0.8P	27	8	13	8	26	ø0.8~ø63	ø16~ø58	1.2
SE-03	85	37	143	116	20	4	4-M6x1P	35	11	15	10.5	32	ø1~ø81	ø24~ø73	2.9
SE-04	110	39	168	140	26	5	4-M6x1P	42	14	19	10	40	ø1~ø100	ø27~ø90	4.3
SE-05	130	45	202	168	32	6	4-M8x1.25P	50	16	21	11.5	49	ø1.5~ø116	ø33~ø106	6.2
SE-06	160	52	248	208	50	8	4-M10x1.5P	65	19	26	15	70	ø1.5~ø160	ø39~ø148	11.1
SE-08	200	55	280	245	58	8	4-M10x1.5P	75	22	24	15	80	ø4~ø200	ø58~ø185	16.3